



Onkaparinga Lodge

Residential Care

28 Liddell Drive
Huntfield Heights SA 5163

Typical room floor plan

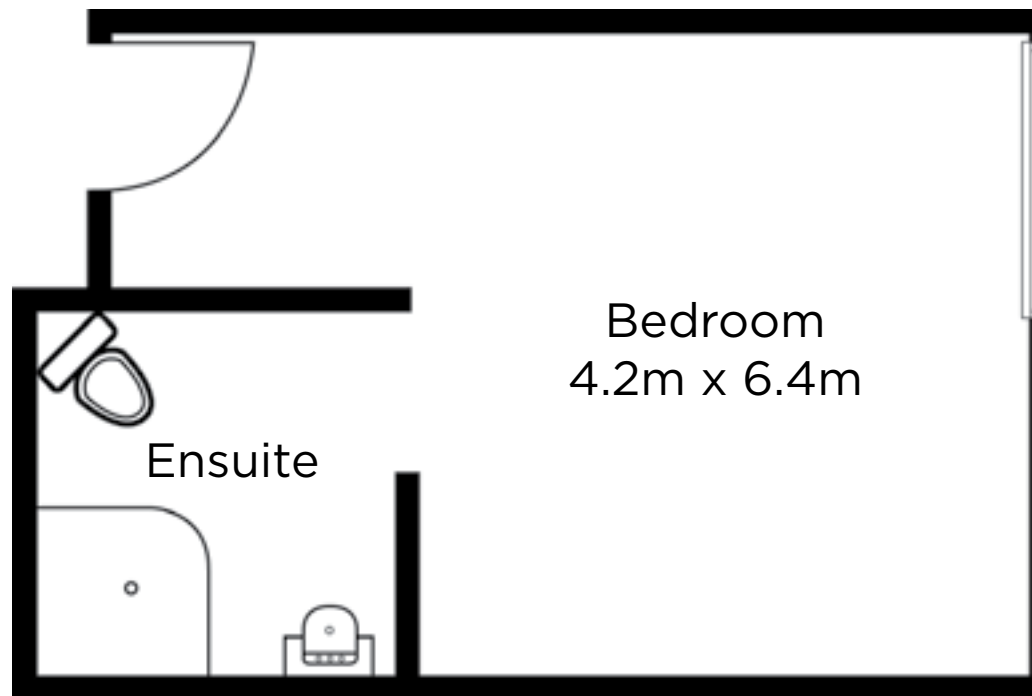

1800 852 772

southerncrosscare.com.au

Specifications and details are indicative only and are subject to change
Southern Cross Care (SA, NT & VIC) Inc ARBN 129 895 905, South Australia, liability limited | Correct as at July 22

Better
for life®

