



Sandpiper Lodge

Residential Care

35 Washington Street
Goolwa SA 5124

Typical room floor plan

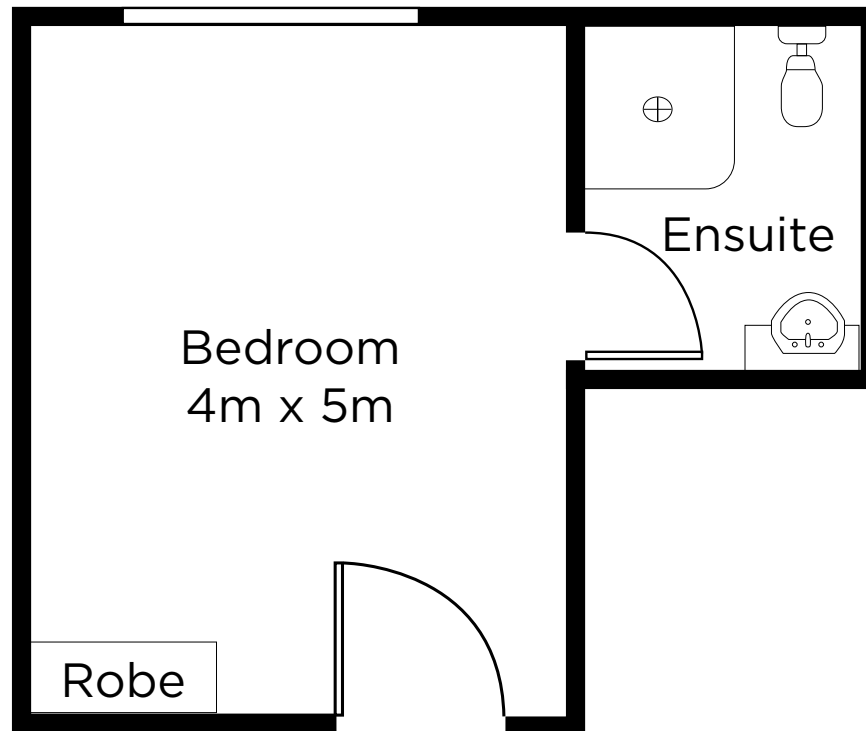

1800 852 772
southerncrosscare.com.au

Specifications and details are indicative only and are subject to change
Southern Cross Care (SA, NT & VIC) Inc ARBN 129 895 905, South Australia, liability limited | Correct as at July 22

**Better
for life®**

