



# The Pines Lodge

Residential Care

342 Marion Road  
North Plympton SA 5037

## Typical room floor plan

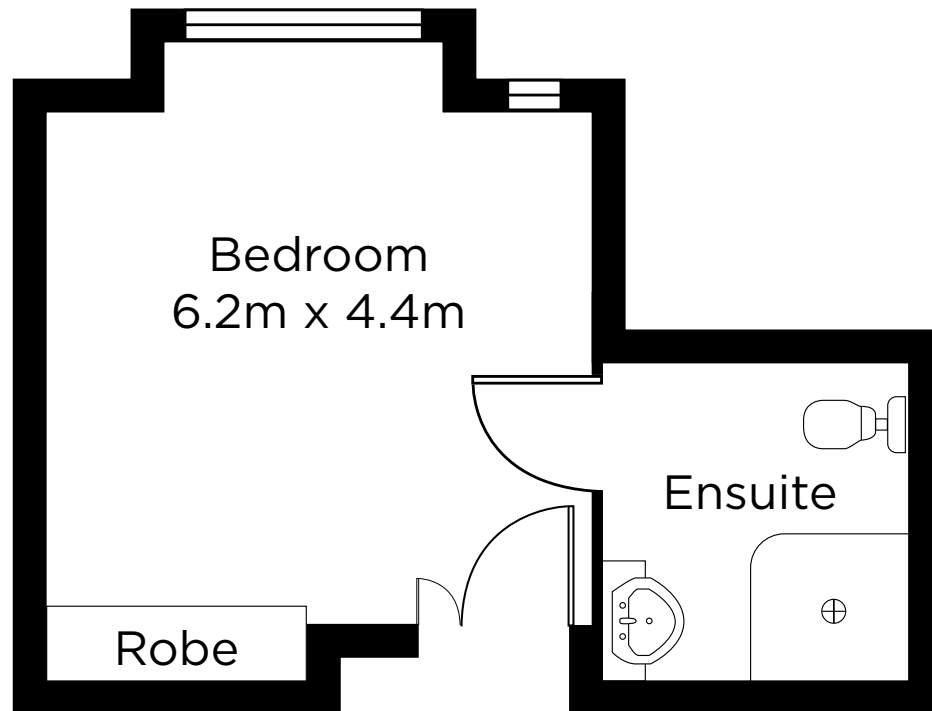

1800 852 772  
[southerncrosscare.com.au](http://southerncrosscare.com.au)

Specifications and details are indicative only and are subject to change  
Southern Cross Care (SA, NT & VIC) Inc ARBN 129 895 905, South Australia, liability limited | Correct as at July 22

Better  
for life®

